

# FOR LEASE

2028 E. Northern Street | Wichita, KS 67216  
Warehouse, Distribution, or Industrial Facility

## FOR MORE INFORMATION, CONTACT

**MARK MICHAELIS**

Mobile: 316-641-2832  
mark@wamllc.com

**CHRIS MADSEN**

Mobile: 316-305-7209  
cmadsen@wamllc.com



## DETAILS

**AVAILABLE SPACE**

10,200 square feet

**LOT SIZE**

24,164 square feet

**ZONING**

Limited Industrial

**PARKING**

5 spaces in south lot

**CEILING HEIGHT**

Approximately 16 feet

**FLOORS**

6-inch reinforced concrete in warehouse.

**LOCATION**

Near the intersection of K-15 and I-235 in South Wichita

**DOCK DOORS**

1 – 15'x12' overhead door with leveler on south side of the building  
1 – 15'x12' drive door with concrete ramp on north side of the building

**ROOF TYPE**

Built up roof with gravel

**HEATING & AIR CONDITIONING**

Warehouse – Fully heated and cooled  
Office – Split unit heat & AC

**EXTERIOR DETAILS**

Red brick and concrete block construction. Asphalt paving with a fence on the south side and a concrete ramp on the north side.



WAMLLC.COM | 316.264.8394 | 1223 N ROCK ROAD | STE E200 | WICHITA, KS 67206

# FOR LEASE

2028 E. Northern Street | Wichita, KS 67216  
Warehouse, Distribution, or Industrial Facility

AERIAL IMAGE



WAMLLC.COM | 316.264.8394 | 1223 N ROCK ROAD | STE E200 | WICHITA, KS 67206

# FOR LEASE

2028 E. Northern Street | Wichita, KS 67216  
Warehouse, Distribution, or Industrial Facility

## FLOOR PLAN

Parcel ID: 087-212-03-0-32-01-018.00-

SGORIONPRQD Expanded Appraisal Card  
Quick Ref: R176770

Tax Year: 2020    Run Date: 3/31/2020 2:55:05 PM

Plot Plan Sketch

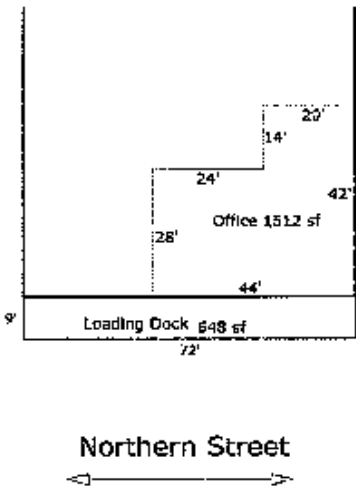

Through The Square 30 units